

Charles Ogle Esq.

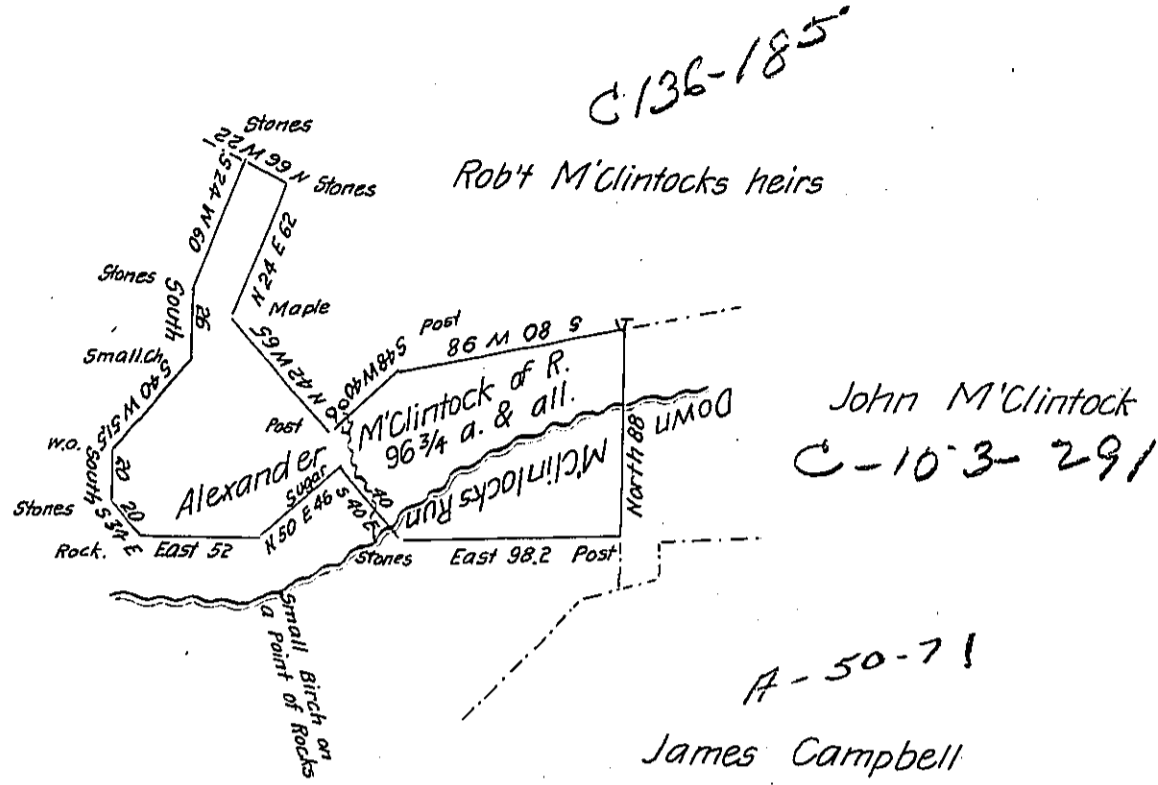

Situate in Addison Township Somerset County and Surveyed
 on the 9th day of January 1841 in pursuance of a Warrant dated October
 19th 1840

Pr.

H.L. Holbrook Deputy

To Jacob Sallade Esq.

Surveyor General

IN TESTIMONY that the above is a copy of the original remaining on file in
 the Department of Internal Affairs of Pennsylvania, made
 conformably to an Act of Assembly approved the 16th day of
 February, 1833, I have hereunto set my Hand and caused
 the Seal of said Department to be affixed at Harrisburg,
 this sixteenth day of April 1906

Loac R. Rowley
 Secretary of Internal Affairs